

PVC HUB (ASTM 3034, SDR 35)
DRIVE INTO CENTER OF RUBBER SLEEVE
PER MANUFACTURE REQUIREMENTS.

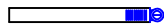

STAINLESS STEEL BAND (9/16" SERIES 300)
TO SECURE UPPER HALF OF RUBBER SLEEVE
TO THE PVC HUB.

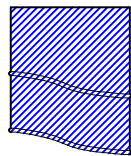

MOLDED RUBBER SLEEVE (ASTM C-443)
INCLUDES MOLDED SEGMENT(S) THAT
HOLD THE SLEEVE IN PLACE.

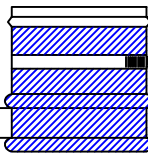

SEE EXPLODED VIEW ABOVE

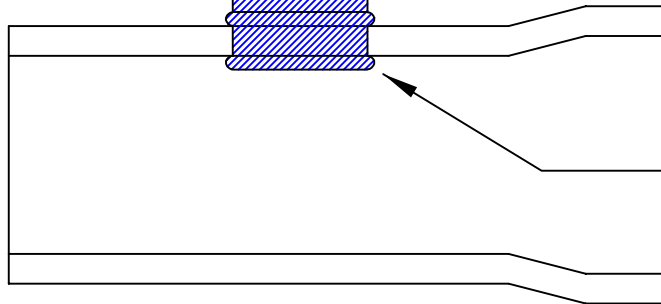

MAINLINE PIPE

HOLES SHALL BE MACHINE DRILLED
WITH ANCHORED CORE DRILLING
MACHINE.

NOTES:

1. INSERTA-TEES ALLOWED ON EXISTING PVC OR DUCTILE IRON SEWER MAINS 12" IN DIA. OR LARGER. SERVICE SADDLES SHALL BE USED ON EXISTING 10" OR SMALLER PIPES (DETAIL 25). MANUFACTURED TEE FITTINGS SHALL BE USED ON ALL NEWLY CONSTRUCTED MAINLINES.
2. THE TAP SHALL NOT BE MADE EXCEPT IN THE PRESENCE OF A CITY INSPECTOR; NOR SHALL ANY CONNECTION BE MADE WITHOUT CITY APPROVAL.
3. CENTERLINE OF TAP SHALL BE ABOVE SPRINGLINE.

**City of
McMinnville**

DETAIL FOR
INSERTA-TEE CONNECTION
TO EXISTING SEWER

DATE:

AUGUST 2022

DRAWING NO.

24